

New York City College of Technology

Theatreworks

Forged in Fire

Ground Plan

Date: 2/16/15

Rev:

Scale:
3/8" = 1'

Plate
1
of 10

Notes:

Des.- Norma Chartoff

Drawn By: Will Griffith

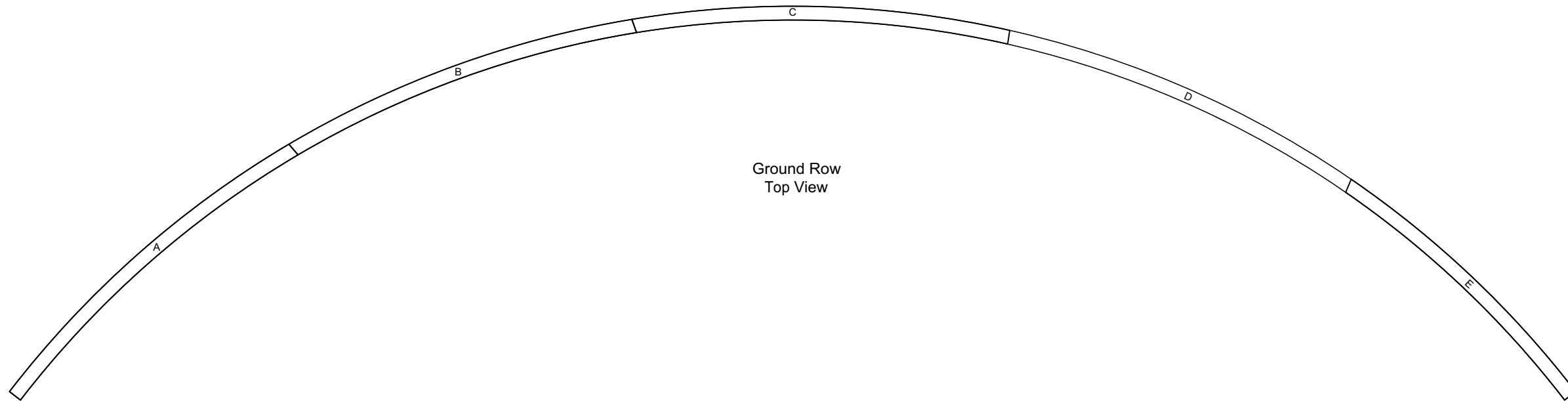

Ground Row
Top View

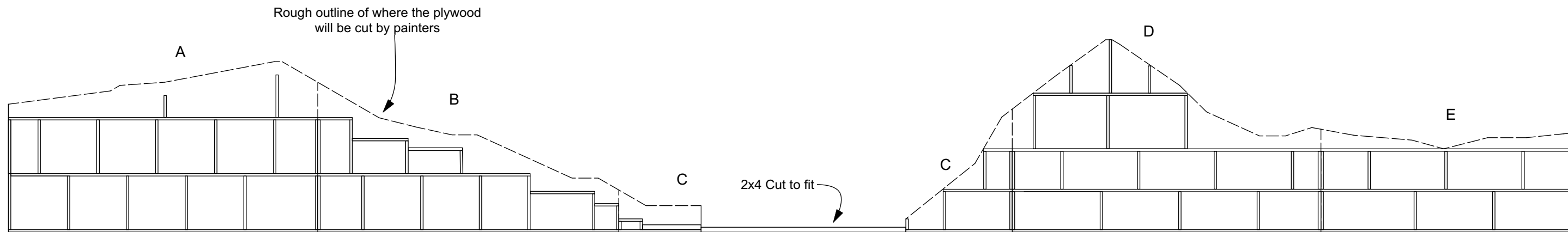

Ground Row
Front View
THIS VIEW IS FLATTENED
Measurements will be accurate but will be built on a curve



New York City College of Technology

Date: 2/16/15

Rev:

Scale:

Plate

Theatreworks

Forged in Fire

Ground Row Overview

3/8" = 1'

2

Notes:

Des.- Norma Chartoff

Drawn By: Will Griffith

of 10

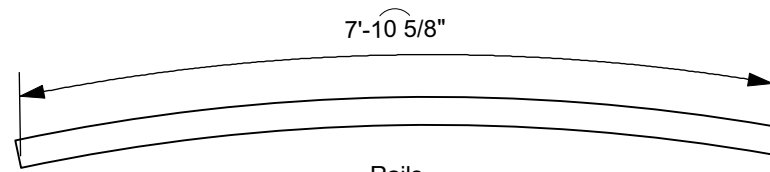

Rails
Top View
CNC Cut- Labeled "A"

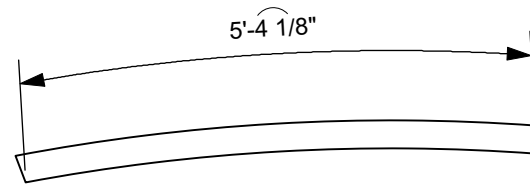

Toggle
Top View- Use CNC cut and cut down
See me for cutting advice

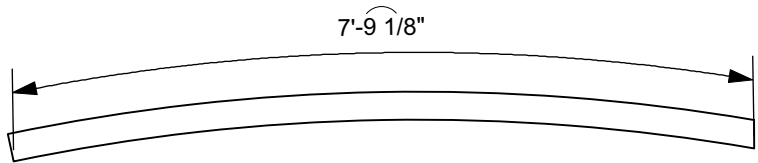

Toggle
Top View- Use CNC cut and cut down
See me for cutting advice

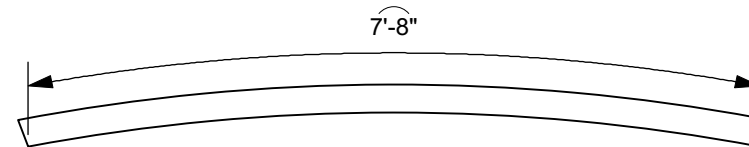

Rail
Top View
CNC Cut- Labeled "B"

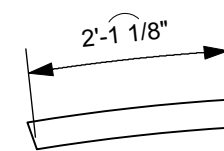

Rail
Top View
CNC Cut- Labeled "C"

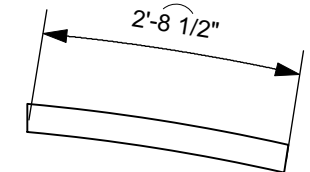

Rail
Top View
CNC Cut- Labeled "C"

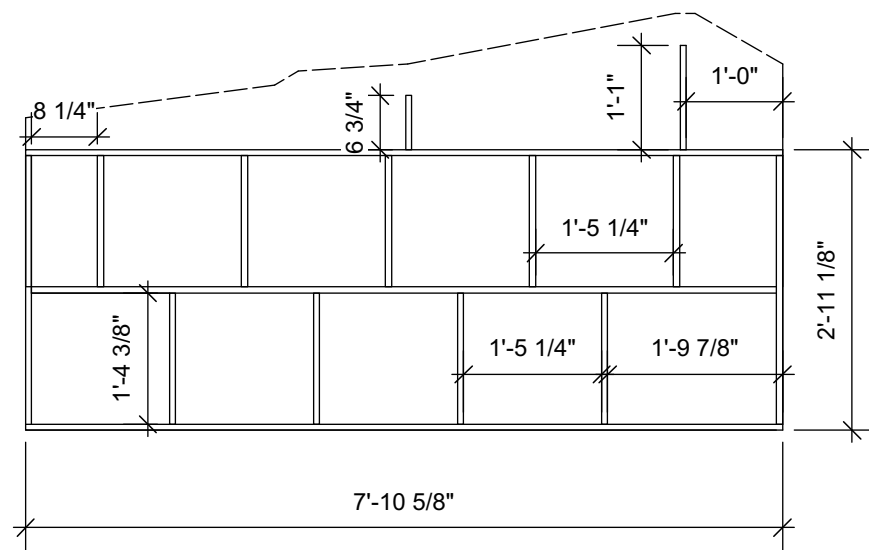

Front View
FLATTENED OUT
Ground Row Section A

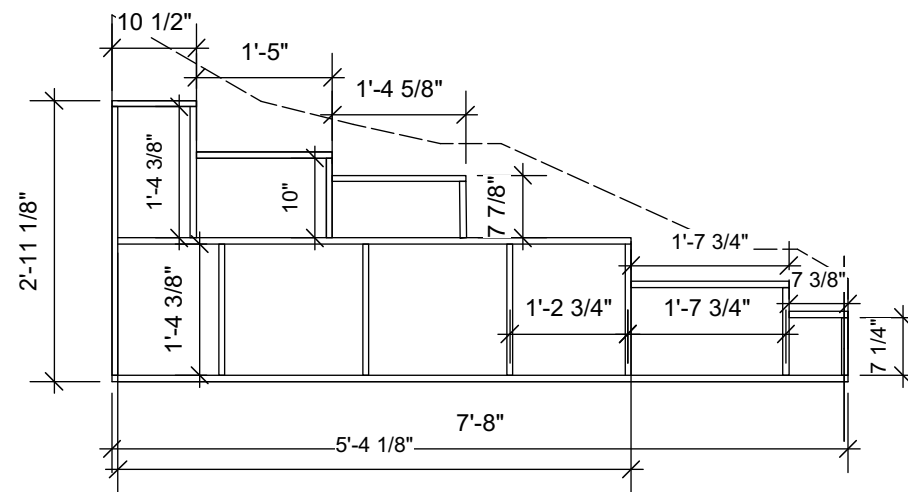

Front View
FLATTENED OUT
Ground Row Section B

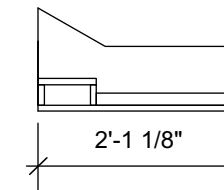

Front View with skin removed
FLATTENED OUT
Ground Row Section C

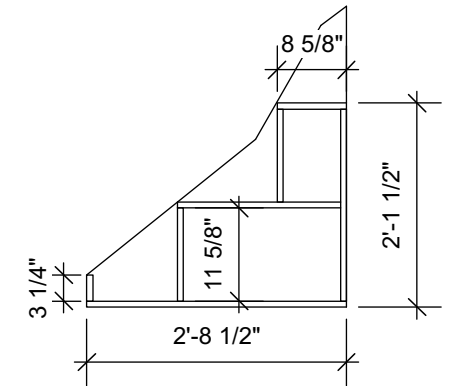

New York City College of Technology

Date: 2/16/15

Rev:

Scale:

Plate

Theatreworks

Forged in Fire

Ground Row Sections A, B, and C

1/2" = 1'

3

Notes:

Des.- Norma Chartoff

Drawn By: Will Griffith

of 10

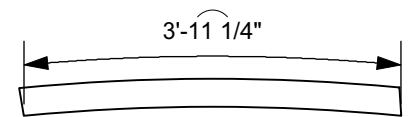

Upper Rail
Top View- Use CNC cut and cut down
See me for cutting advice

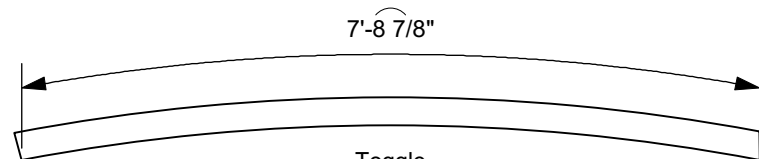

Toggle
Top View- Use CNC cut and cut down
See me for cutting advice

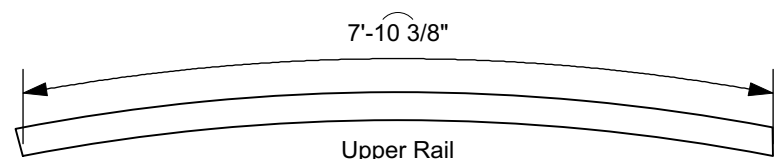

Upper Rail
Top View
CNC Cut- Labeled "D "

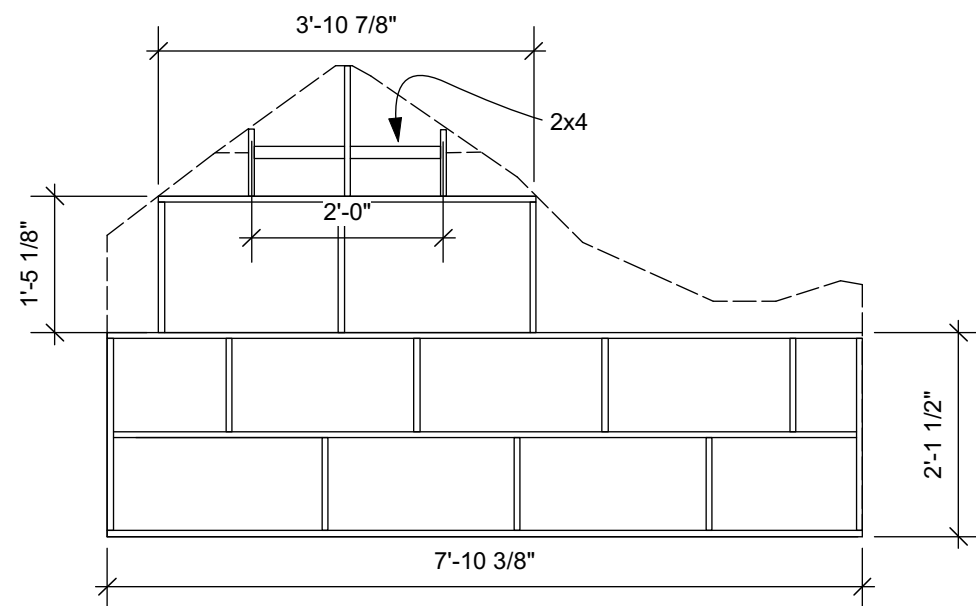

Front View
FLATTENED OUT
Ground Row Section D

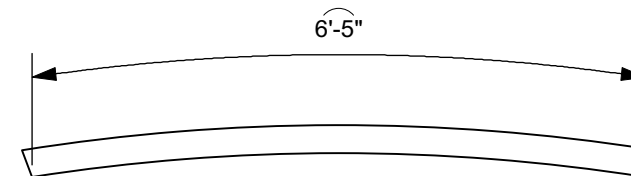

Toggle
Top View- Use CNC cut and cut down
See me for cutting advice

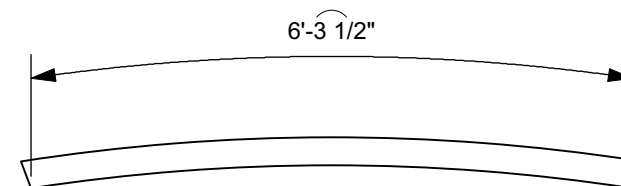

Upper Rail
Top View
CNC Cut- Labeled "E"

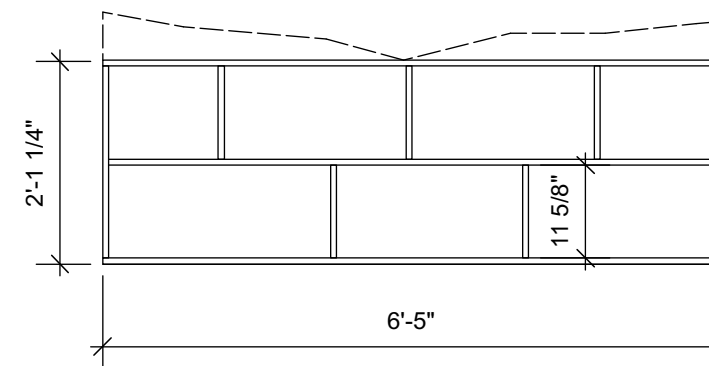

Front View
FLATTENED OUT
Ground Row Section E



New York City College of Technology

Theatreworks

Forged in Fire

Ground Row Sections D & E

Date: 2/16/15

Rev:

Scale:

1/2" = 1'

Plate

4

Notes:

Des.- Norma Chartoff

Drawn By: Will Griffith

of 10

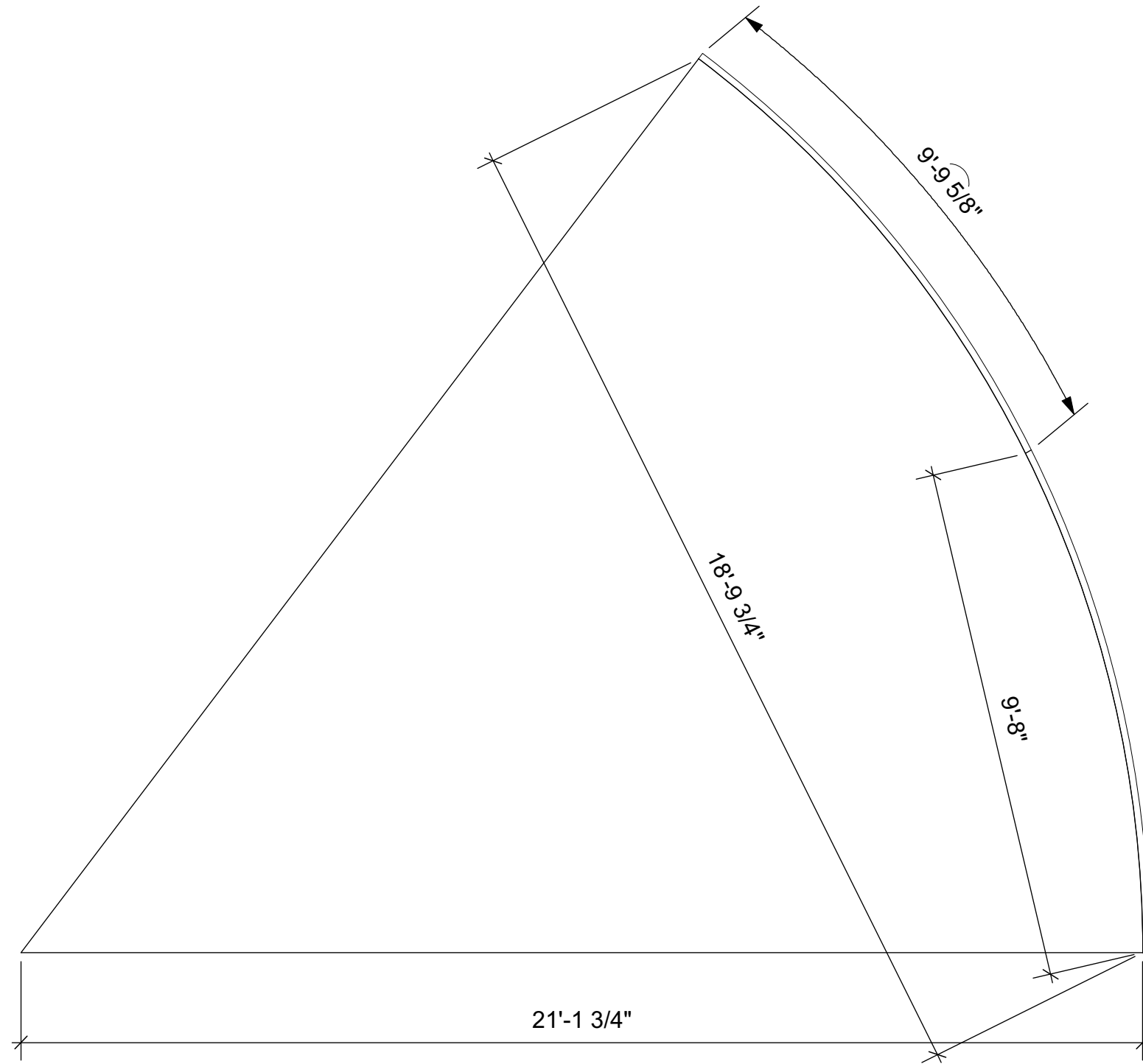

New York City College of Technology

Date: 2/16/15

Rev:

Scale:

Plate

Theatreworks

Forged in Fire

Backdrop Pipe Layout

3/8"=1'

5

Notes: 1 1/2" Schedule 40 Pipe. All Dimensions are for the Inside Diameter

Des.- Norma Chartoff

Drawn By: Will Griffith

of 10

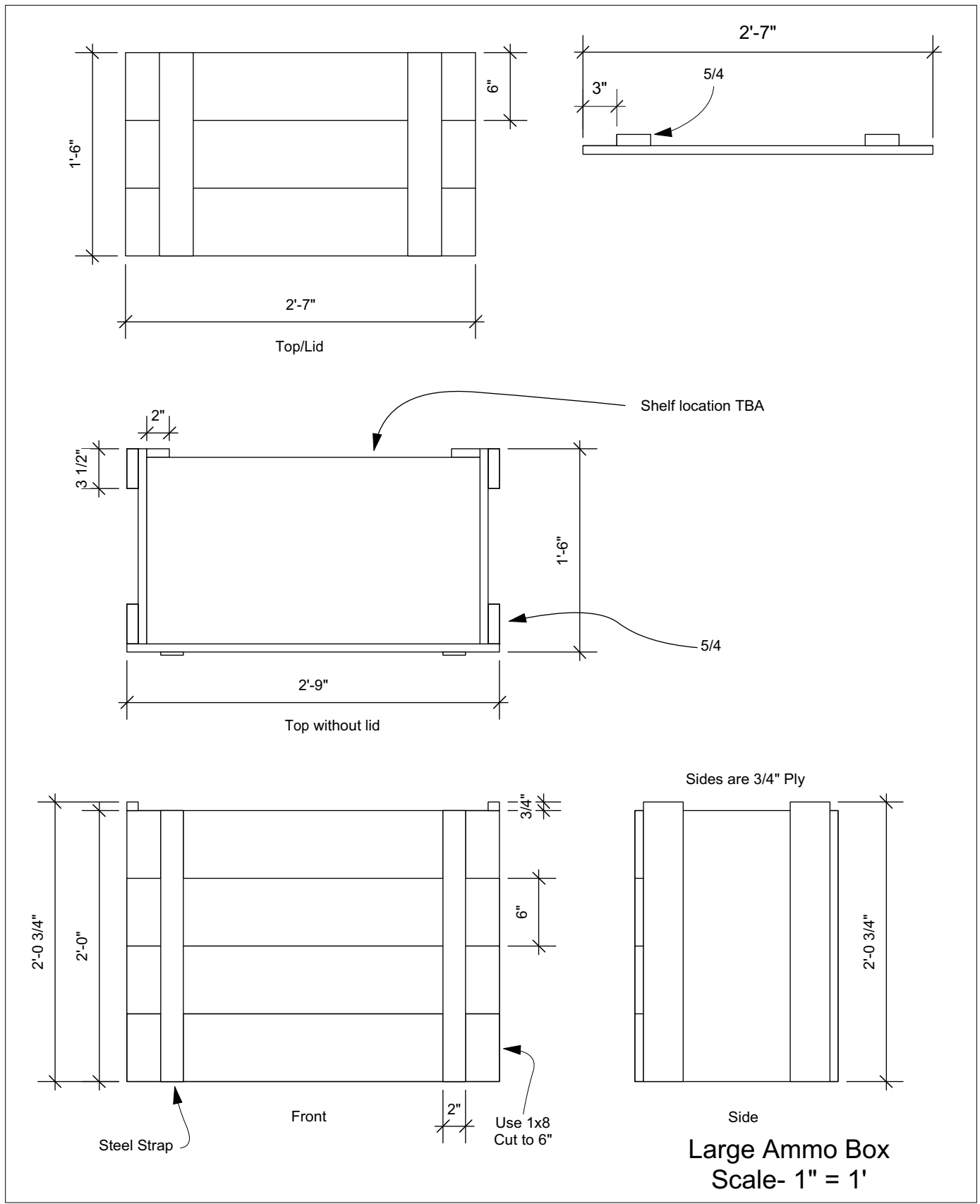
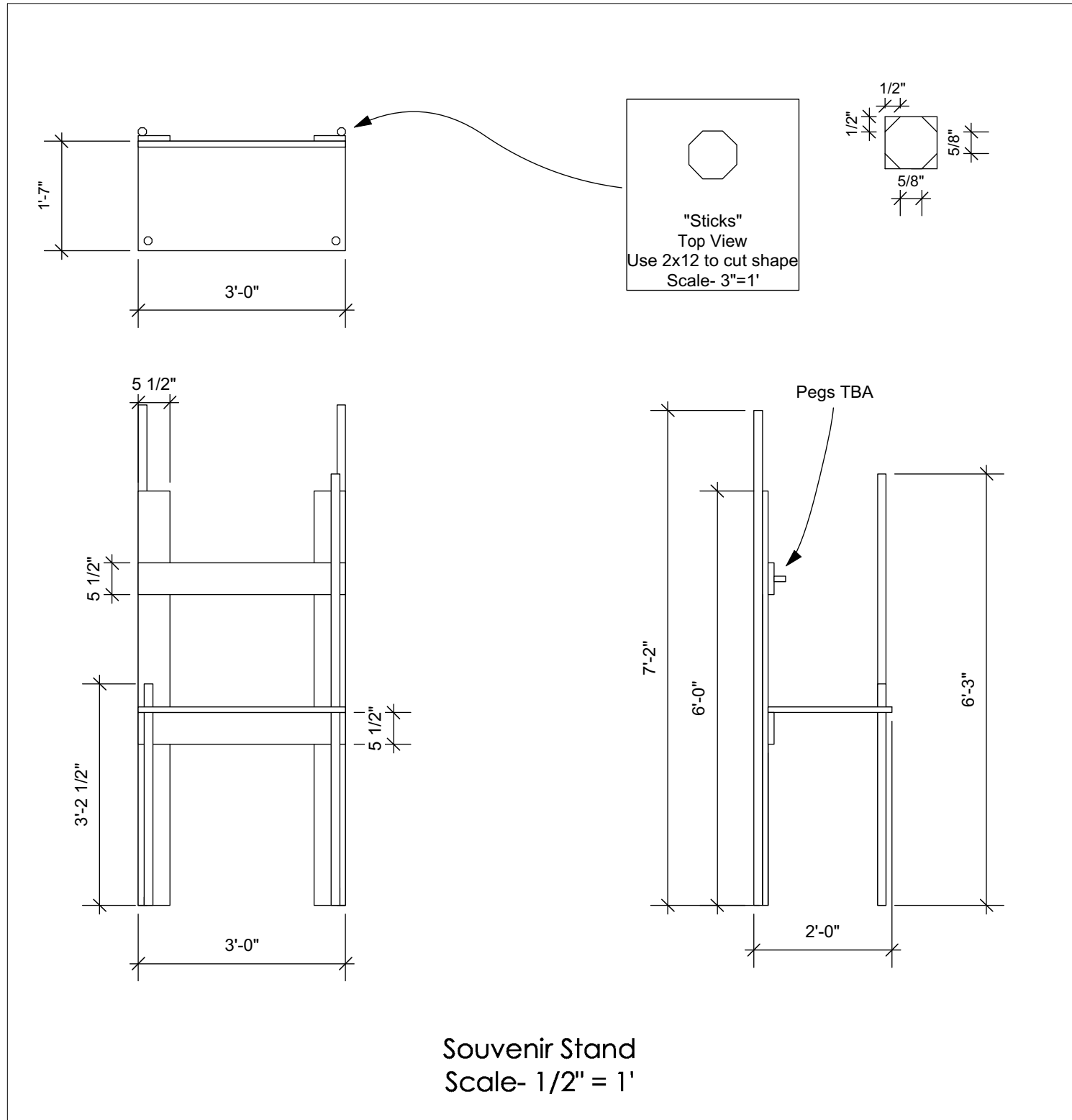

New York City College of Technology

Theatreworks

Forged in Fire

Souvenir Stand and Ammo Box

Date: 2/16/15

Rev:

Scale:

Plate

See Above

6

Notes:

Des.- Norma Chartoff

Drawn By: Will Griffith

of 10

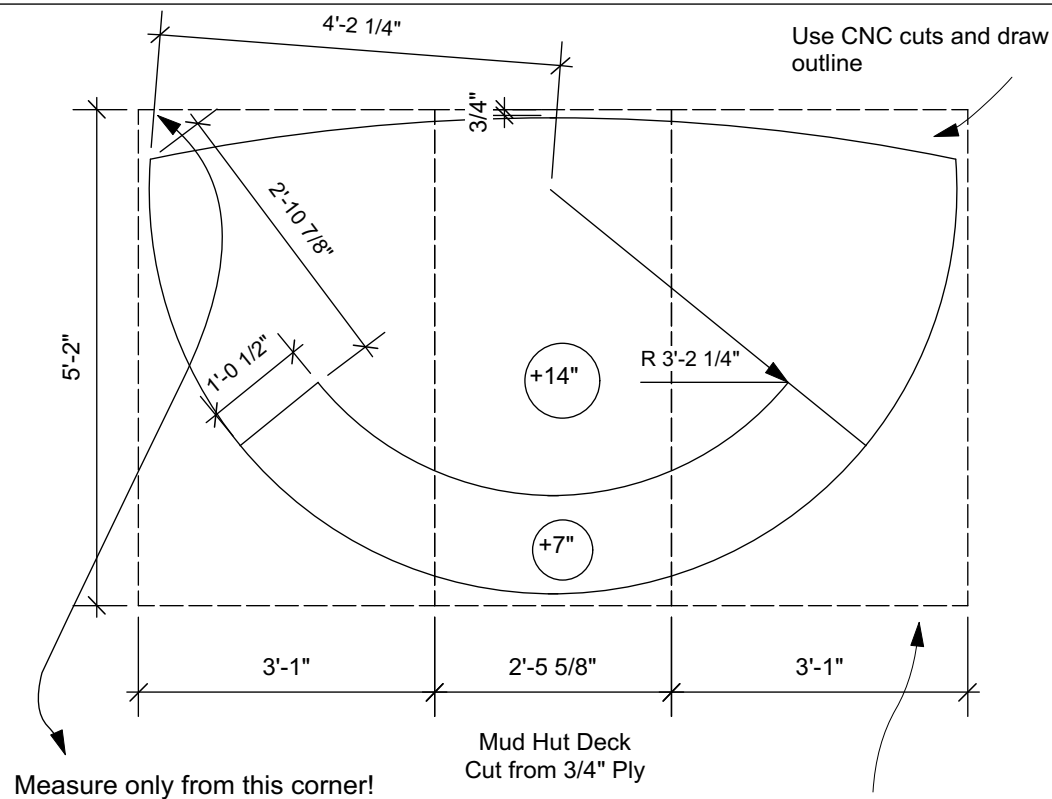

Measure only from this corner!

Dashed lines indicate 3/4" ply sheets. Lay out sheets and cut curves to match. Use the offcut to lay out the lower (7") curve.

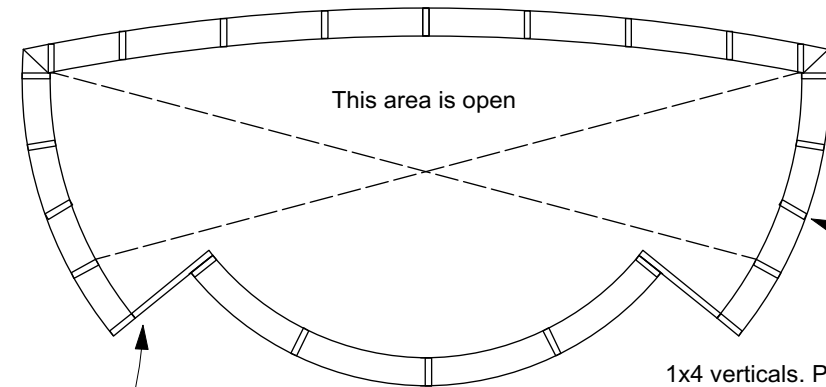
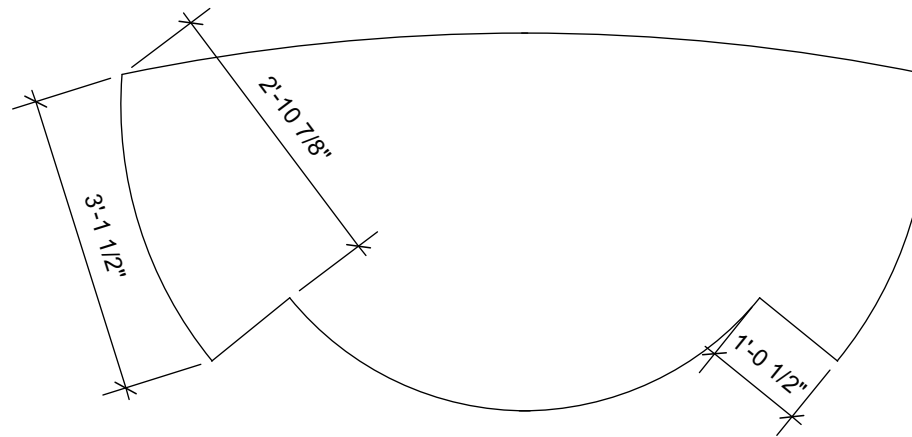
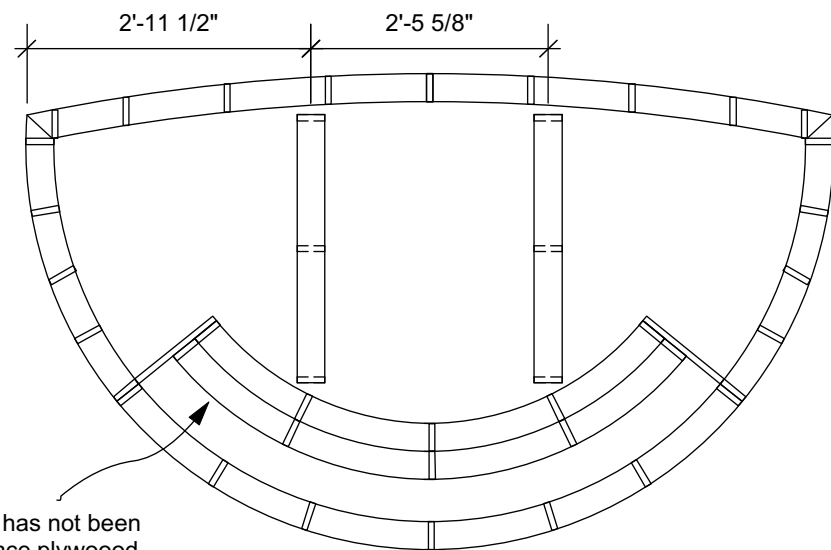

3/4" Ply. Will need to be scabbed on the inside.

1x4 verticals. Placement does not need to be precise so long as there is no more than 2' between each vertical. See me for more information.

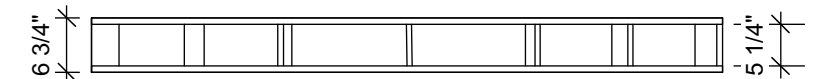
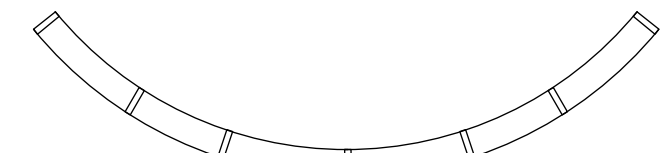
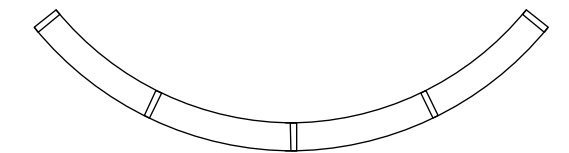
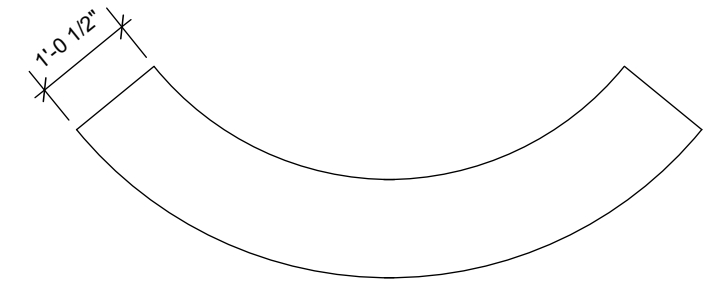
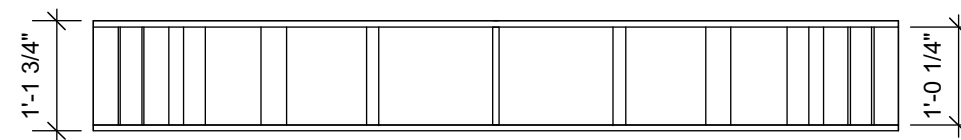

New York City College of Technology

Date: 2/16/15

Rev:

Scale:

Plate

Theatreworks

Forged in Fire

Mud Hut

1/2" = 1'

7

Notes:

Des.- Norma Chartoff

Drawn By: Will Griffith

of 10

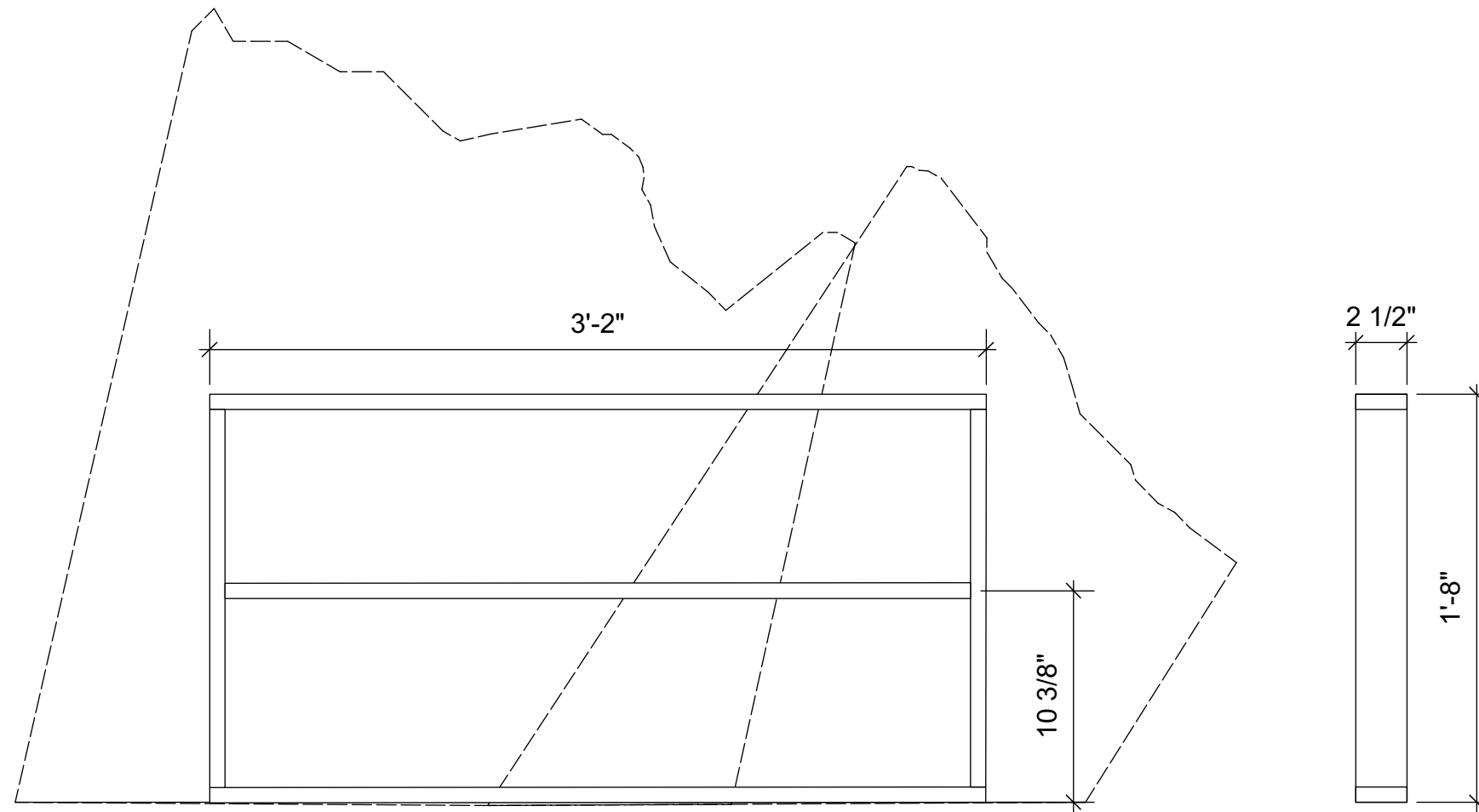

Front view with skin removed(skin is dotted line)

Side View



New York City College of Technology

Date: 2/16/15

Rev:

Scale:

Plate

Theatreworks

Forged in Fire

Backing Flat for Sheet Steel

1 1/2"=1'

8

Notes: Designer will layout cuts for sheet steel

Des.- Norma Chartoff

Drawn By: Will Griffith

of 10

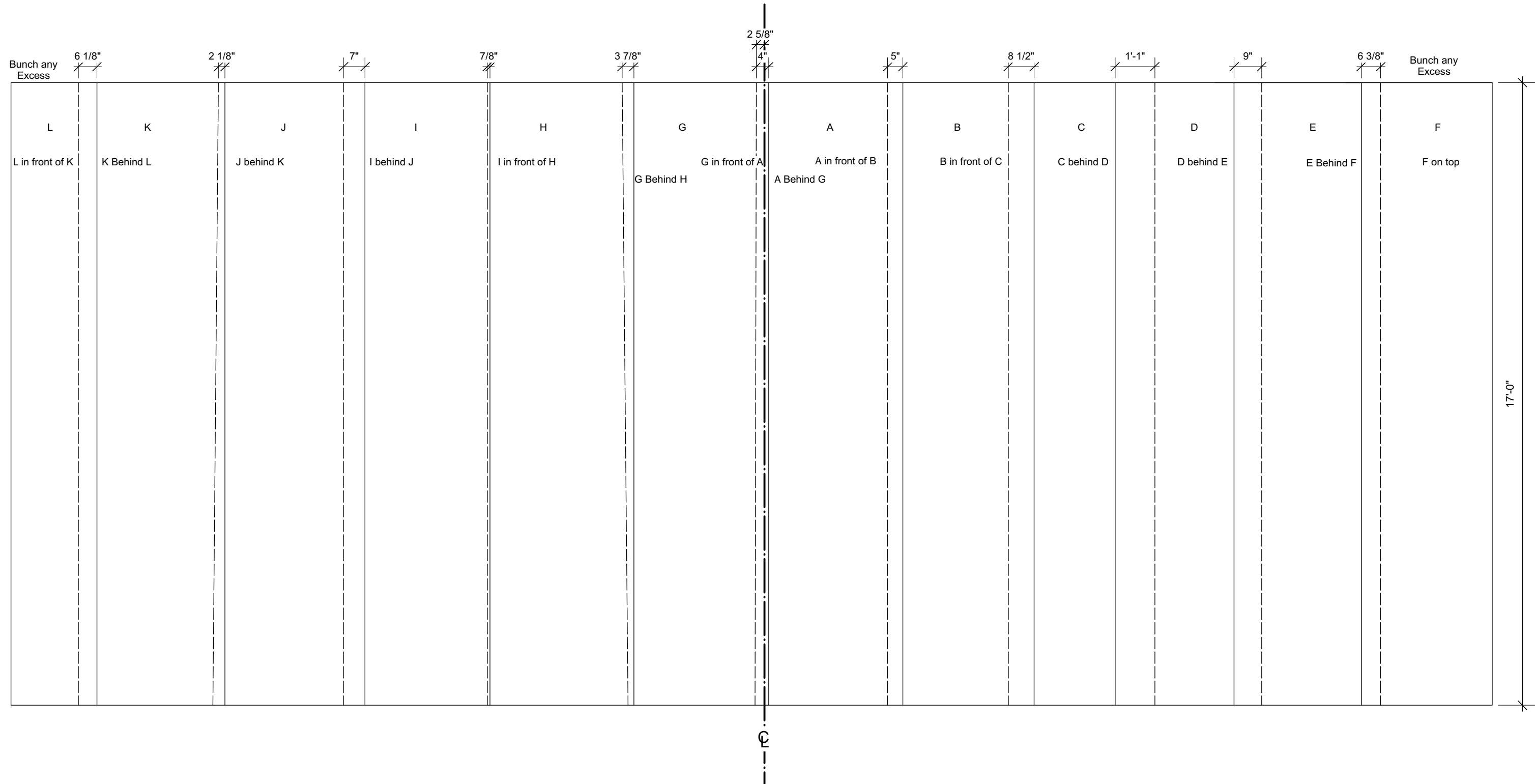

New York City College of Technology

Date: 2/16/15

Rev:

Scale:

Plate

Theatreworks

Forged in Fire

Erosion Cloth Layout

3/8"=1'

9

Notes: See designer for cut and distressing locations

Des.- Norma Chartoff

Drawn By: Will Griffith

of 10

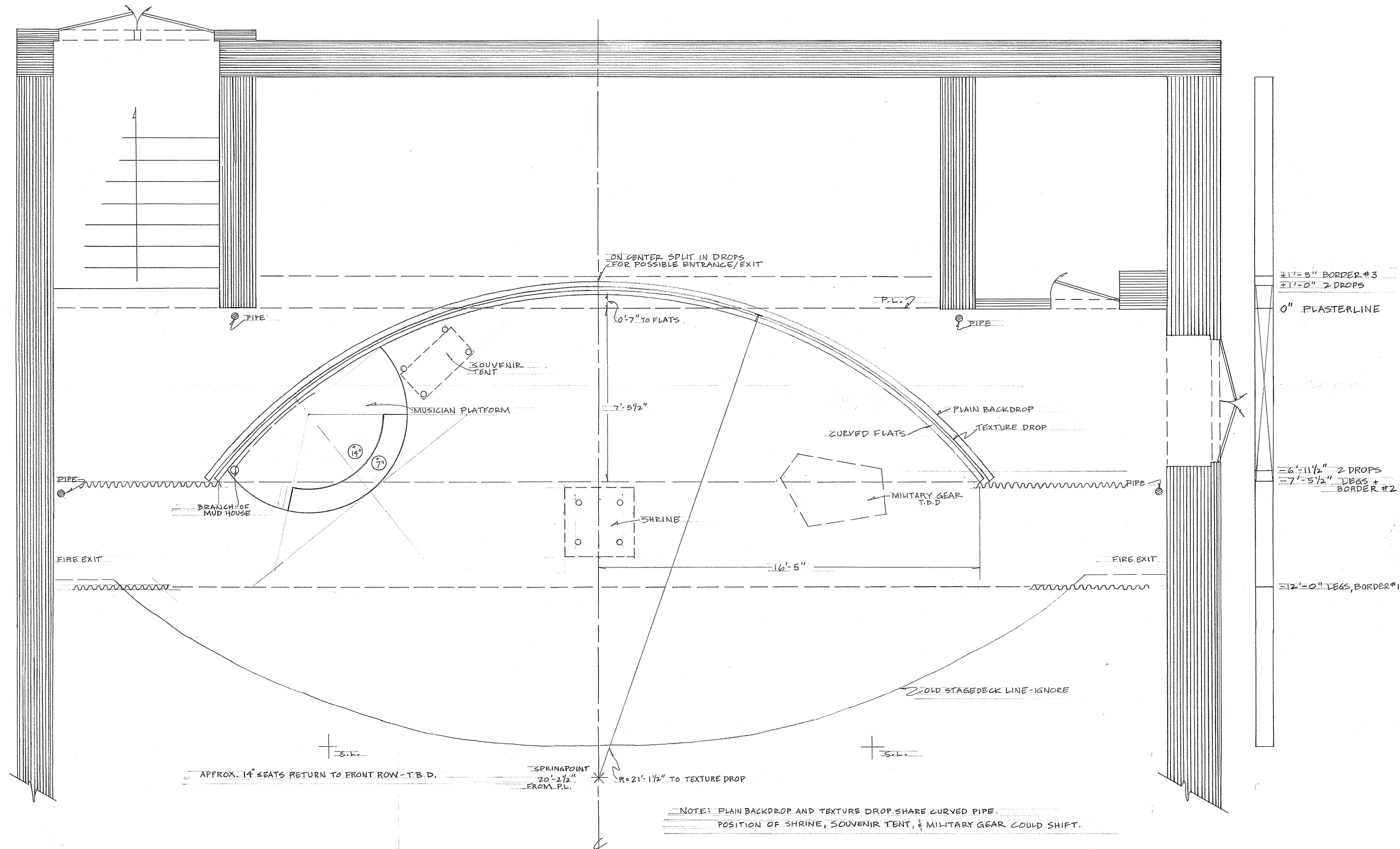

New York City College of Technology

Theatreworks

Forged in Fire

Designer Ground Plan

Date: 2/16/15

Rev:

Scale:

Plate

NTS

10

Notes: See designer for cut and distressing locations

Des.- Norma Chartoff

Drawn By: Will Griffith

of 10